



Walworth County, Wisconsin

News Release

For more information contact:
Joe Kroll, Walworth County
County Engineer/Assistant Director
(262) 741-3441

For Immediate Release

Elkhorn, Wisconsin – March 26, 2015

CTH J in Town of East Troy to be Closed for Lake Beulah Dam Construction Project

The upcoming replacement of the Lake Beulah Dam Spillway located in the Town of East Troy will necessitate the closing of CTH J for several months. Terra Engineering and Construction, the contractor awarded this construction project, anticipates beginning its work the week of April 13th and CTH J will then be closed at the construction site for the duration of the project which is anticipated to be completed by mid-August.

The recommended detour map is included here and is also posted on the county website. Look for the “Highway Updates” Link on the Walworth County home page.

Motorists travelling east on CTH J to Mukwonago from the Whitewater and LaGrange areas could consider taking STH 20 to I-43 rather than the posted detour. Motorists travelling west on CTH J should also consider taking STH 20 as well as other alternative routes. The County will place large message boards on CTH J notifying motorists of the upcoming road closure at the Lake Beulah Dam.

###

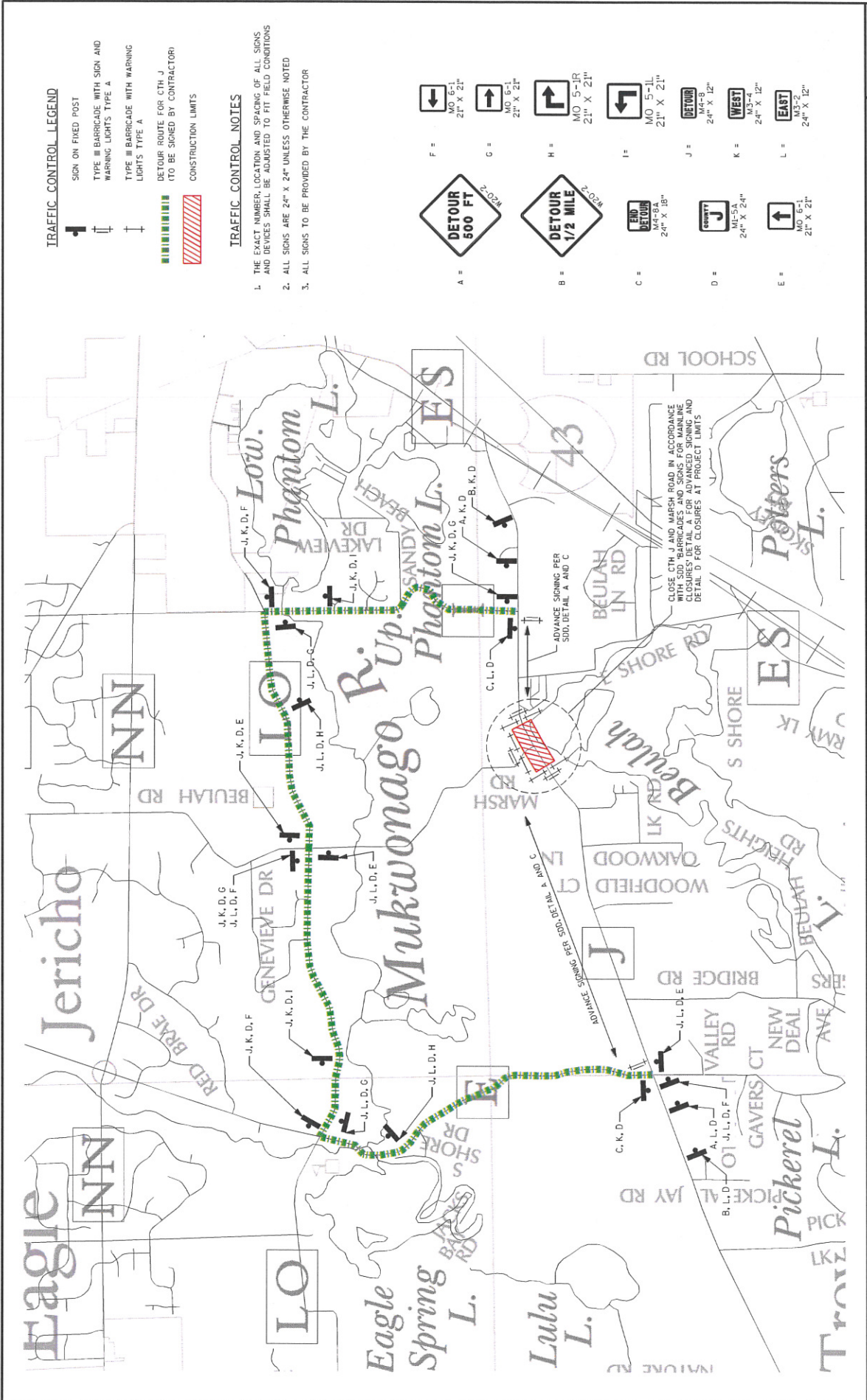

TRAFFIC CONTROL LEGEND

- SIGN ON FIXED POST
- TYPE III BARRICADE WITH SIGN AND WARNING LIGHTS, TYPE A
- TYPE III BARRICADE WITH WARNING LIGHTS TYPE A
- DETOUR ROUTE FOR CTH J (TO BE SIGNED BY CONTRACTOR)
- CONSTRUCTION LIMITS

TRAFFIC CONTROL NOTES

1. THE EXACT NUMBER, LOCATION AND SPACING OF ALL SIGNS AND DEVICES SHALL BE ADJUSTED TO FIT FIELD CONDITIONS
2. ALL SIGNS ARE 24" X 24" UNLESS OTHERWISE NOTED
3. ALL SIGNS TO BE PROVIDED BY THE CONTRACTOR

A =		F =	
B =		G =	
C =		H =	
D =		I =	
E =		J =	
		K =	
		L =	

CLOSE CTH J AND MARSH ROAD IN ACCORDANCE WITH SDD BARRICADES AND SIGNS FOR MAINLINE CLOSURES PER DETAIL D FOR SIGNING AND DETAIL D FOR CLOSURES AT PROJECT LIMITS

ADVANCE SIGNING PER SDD DETAIL A AND C

ADVANCE SIGNING PER SDD DETAIL A AND C